



Property Highlights

- Space includes: Fully furnished, exterior window, glass light entry door
- Space has hallway access to building common area, kitchen and restrooms
- Rent includes all utilities + internet
- 4.5/1,000 SF parking
- Close proximity to 1-8, 125, 52 & 67 fwys
- **Lease rate: \$495/month**

FOR LEASE - Appromixate 170 SF Useable 2nd Floor Office Space

Fletcher Hills Office Space

2295 Fletcher Parkway, Suite 202 | El Cajon, CA 92020

Contact

CAMERON CZUBERNAT
619.462.5100
cameron@cpgsd.com
CA Lic. 01383317

KERRY SCHIMPP
619.462.3100
Kerry@cpgsd.com
CA Lic. 00955075

2295 Fletcher Parkway, Suite 200
El Cajon, CA 92020
www.cpgsd.com

CPG | COMMERCIAL
PROPERTIES
GROUP
INTEGRITY - KNOWLEDGE - EXPERIENCE

Floor Plan

Second Floor

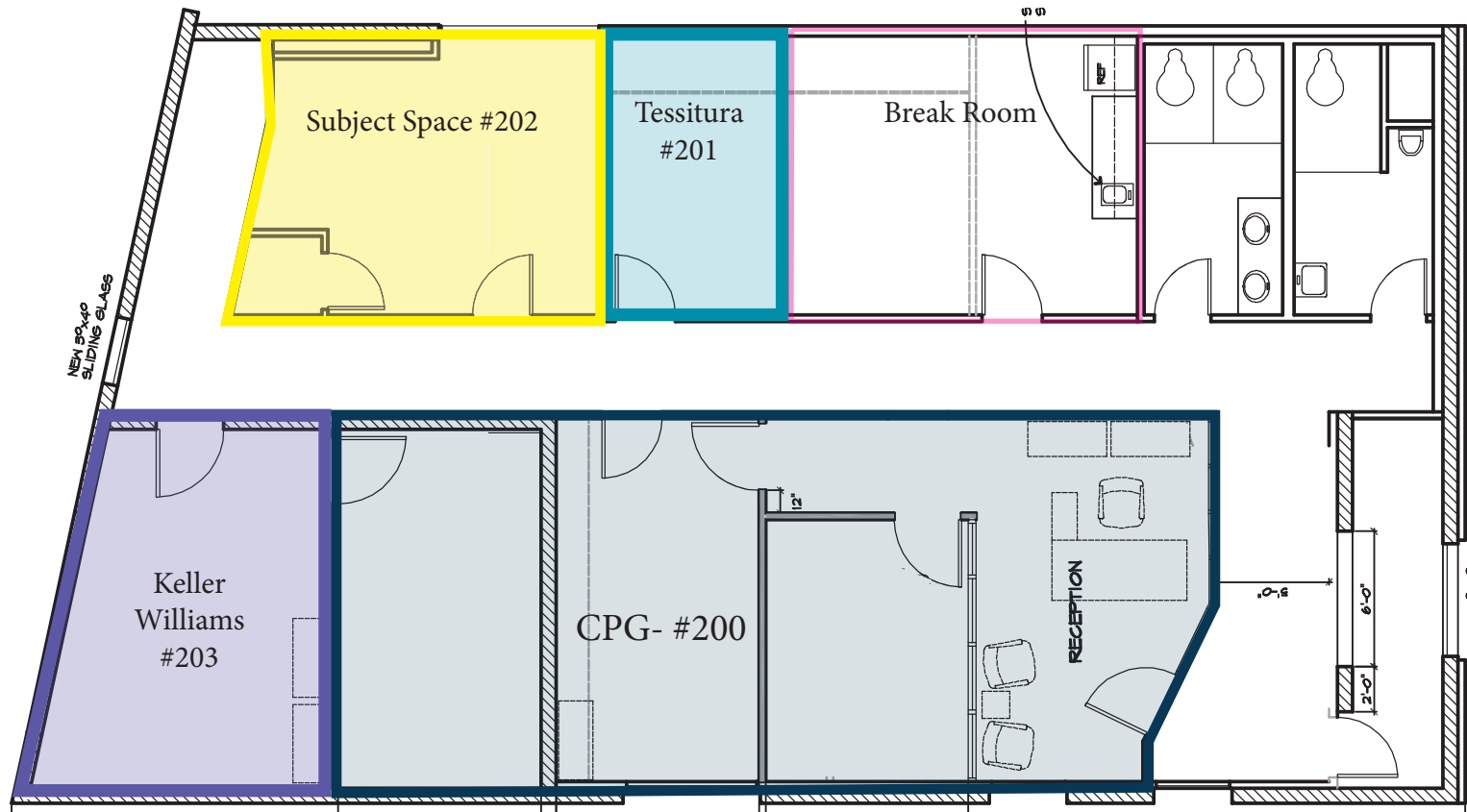

The information contained herein has been given to us by the owner of the property or other sources we deem reliable. We have no reason to doubt its accuracy, but we do not guarantee it. All information should be verified prior to purchase or lease.

Contact

CAMERON CZUBERNAT
619.462.5100
cameron@cpgsd.com
CA Lic. 01383317

KERRY SCHIMPF
619.462.3100
Kerry@cpgsd.com
CA Lic. 00955075

2295 Fletcher Parkway, Suite 200
El Cajon, CA 92020
www.cpgsd.com

CPG | COMMERCIAL
PROPERTIES
GROUP
INTEGRITY - KNOWLEDGE - EXPERIENCE



2295
Fletcher Pkwy
El Cajon, CA



The information contained herein has been given to us by the owner of the property or other sources we deem reliable. We have no reason to doubt its accuracy, but we do not guarantee it. All information should be verified prior to purchase or lease.

Contact

<p>CAMERON CZUBERNAT 619.462.5100 cameron@cpgsd.com CA Lic. 01383317</p>	<p>KERRY SCHIMPF 619.462.3100 Kerry@cpgsd.com CA Lic. 00955075</p>
---	---

2295 Fletcher Parkway, Suite 200
El Cajon, CA 92020
www.cpgsd.com

CPG | COMMERCIAL
PROPERTIES
GROUP
INTEGRITY - KNOWLEDGE - EXPERIENCE